

PLAT OF SURVEY

PART OF THE NORTHWEST 1/4 OF SECTION 35, TOWNSHIP 37 NORTH, RANGE 5, EAST OF THE THIRD PRINCIPAL MERIDIAN, DESCRIBED AS FOLLOWS:

BEGINNING AT THE NORTHWEST CORNER OF LOT 3, BLOCK 16 OF DAVIS' EXTENDED ADDITION TO SANDWICH, ILLINOIS; THENCE SOUTH 77 DEGREES 28 MINUTES WEST ALONG THE SOUTHERLY RIGHT OF WAY LINE OF THE CHICAGO, BURLINGTON AND QUINCY RAILROAD'S AURORA TO GALESBURG LINE 923.01 FEET; THENCE SOUTH 12 DEGREES 32 MINUTES EAST 77.45 FEET TO THE NORTHERLY RIGHT OF WAY LINE OF STATE ROUTE 34 FOR A POINT OF BEGINNING; THENCE NORTH 12 DEGREES 32 MINUTES WEST, 77.45 FEET TO SAID SOUTHERLY RIGHT OF WAY LINE; THENCE SOUTH 77 DEGREES 28 MINUTES WEST ALONG SAID RIGHT OF WAY LINE 117.46 FEET; THENCE SOUTH 13 DEGREES 02 MINUTES 56 SECONDS WEST 74.84 FEET TO SAID NORTHERLY RIGHT OF WAY LINE OF STATE ROUTE 34; THENCE EASTERLY ALONG SAID NORTHERLY RIGHT OF WAY LINE ALONG A CURVE BEING CONCAVE TO THE SOUTH HAVING A RADIUS OF 14,263.60 FEET, A DISTANCE OF 116.84 FEET TO THE POINT OF BEGINNING, IN THE CITY OF SANDWICH, DEKALB COUNTY, ILLINOIS.

THE CENTER OF THE CURVE OF U. S. ROUTE #34 IS TO THE NORTH, THE CURVE BEING IN ITS CONCAVITY TO THE NORTH, RATHER THAN THE SOUTH



KRISTINE LARSEN, ATTY.

ORDER NO. 13 J 4B

FILE NO. 13510

3 S.S.
MALL

CERTIFY THAT I, AN ILLINOIS LAND SURVEYOR, THE PROPERTY DESCRIBED ABOVE AND THAT THIS IS A CORRECT REPRESENTATION OF SAID PROFESSIONAL SERVICE CONFORMS TO THE MINIMUM STANDARDS OF A BOUNDARY SURVEY. MY HAND AND SEAL AT OSWEGO, ILLINOIS, OCTOBER 13, A.D., 2013.

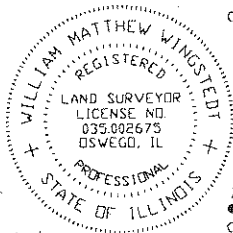

FIELD WORK COMPLETED, BUILDINGS AND OTHER IMPROVEMENTS LOCATED AS SHOWN ON THE 30TH OF OCTOBER, A.D., 2013.

723 W CHURCH.DWG
● = found iron stake
○ = set iron stake

SURVEYOR NO. 035.002675
TO RENEWAL AND EXPIRES 11/30/2014
OR GUARANTEE POLICY FOR RESTRICTIONS NOT SHOWN ON SURVEY.
BEARINGS, WHERE SHOWN, ARE BASED ON A DATUM LINE.
ALL POINTS BEFORE BUILDING AND REPORT ANY APPARENT DISCREPANCIES

WILLIAM M. WINGSTEDT
ILLINOIS PROFESSIONAL LAND SURVEYOR
329 WHITE PINES CT., OSWEGO, ILLINOIS 60543
PHONE: (630) 554-8209 FAX (630) 551-1207